

Customer Contact Sheet - Lamp Design

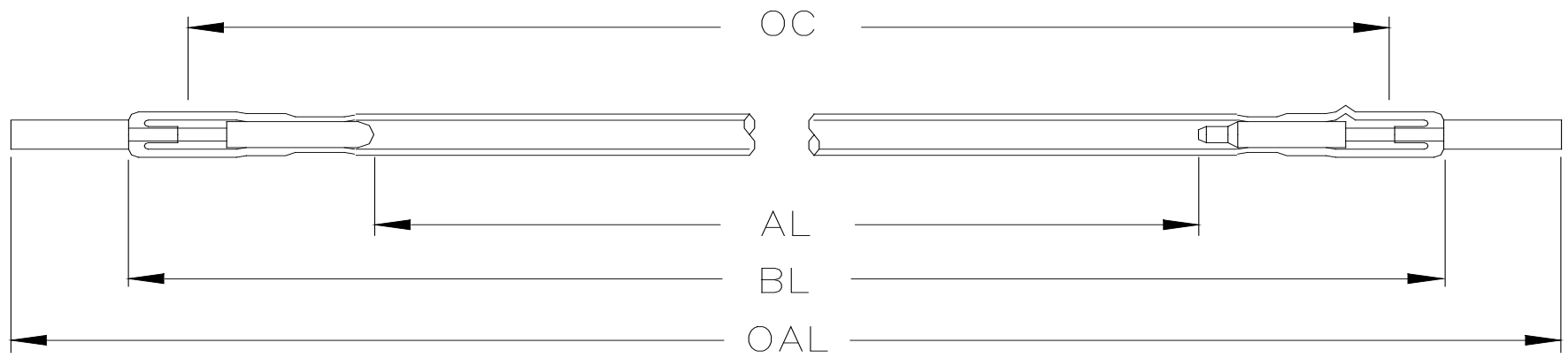

Please provide as much information as possible - fields marked in RED (*) are mandatory

Customer Information

Company *: _____ Lamp reference: _____
 Contact *: _____ Telephone: _____
 Address: _____ Fax: _____
 _____ email: _____
 Country *: _____ Web address *: http:// _____

Application *

IPL Medical Laser Industrial Laser Other Laser Other Application

Export Compliance Information *

Application: Commercial Military ^o Nuclear ^o Details: _____
 (^o Please contact local Trade Compliance Manager immediately)

Commercial Information

Samples Required: Yes Qty: _____ Estimated Qty/yr _____
 Timescales _____ Target price _____

Lamp Dimensions

Arc Length (AL) * _____ mm Overall Length (OAL) _____ mm Pass Through Diameter * _____ mm
 Body Length (BL) _____ mm Quartz I.D. (bore) * _____ mm Side arm position _____
 O-ring Centres (OC) _____ mm Quartz O.D. * _____ mm

Finishing Detail

Base		Flying Leads	
Length: _____ mm		Length: _____ mm	
Outside Diameter: _____ mm		Gauge: _____	
Material: _____		Insulation: _____	
Offset: Yes <input type="checkbox"/> No <input type="checkbox"/>		Max Non-Flex: _____ mm	

Envelope Material *

- Clear Fused Quartz (CFQ)
- Titanium Doped Quartz (TDQ)
- Cerium Doped Quartz (CDQ)
- Synthetic Fused Quartz (SFQ)

Lamp Type & Operation

Continuous (CW) Current * _____ A Voltage * _____ ± _____ V

Pulse

Pulse Forming Network (PFN)	Square Wave	Cooling *	Gas Fill / Pressure *
Capacitance _____ μF	Current _____ A	<input type="checkbox"/> Ambient Air	<input type="checkbox"/> Krypton
Inductance _____ μH	Voltage _____ V	<input type="checkbox"/> Forced Air	<input type="checkbox"/> Xenon
Voltage _____ V	Energy _____ J	<input type="checkbox"/> Water	<input type="checkbox"/> Mix _____ Pressure _____

General Electrical

Pulse Width * _____ μs/ms Rep Rate * _____ Hz Simmer Current * _____ mA Trigger Voltage _____ V
 Ko _____ @A² Pulse Train Yes No Simmer Voltage _____ V Trigger Form:
 Average Pwr _____ W Details _____ o/c Simmer V * _____ V Series Parallel External

Additional Information / Special Requirements